

LANTERN JACK™

Installation and Operating Instructions

Keep all plastic and wire parts away from children.

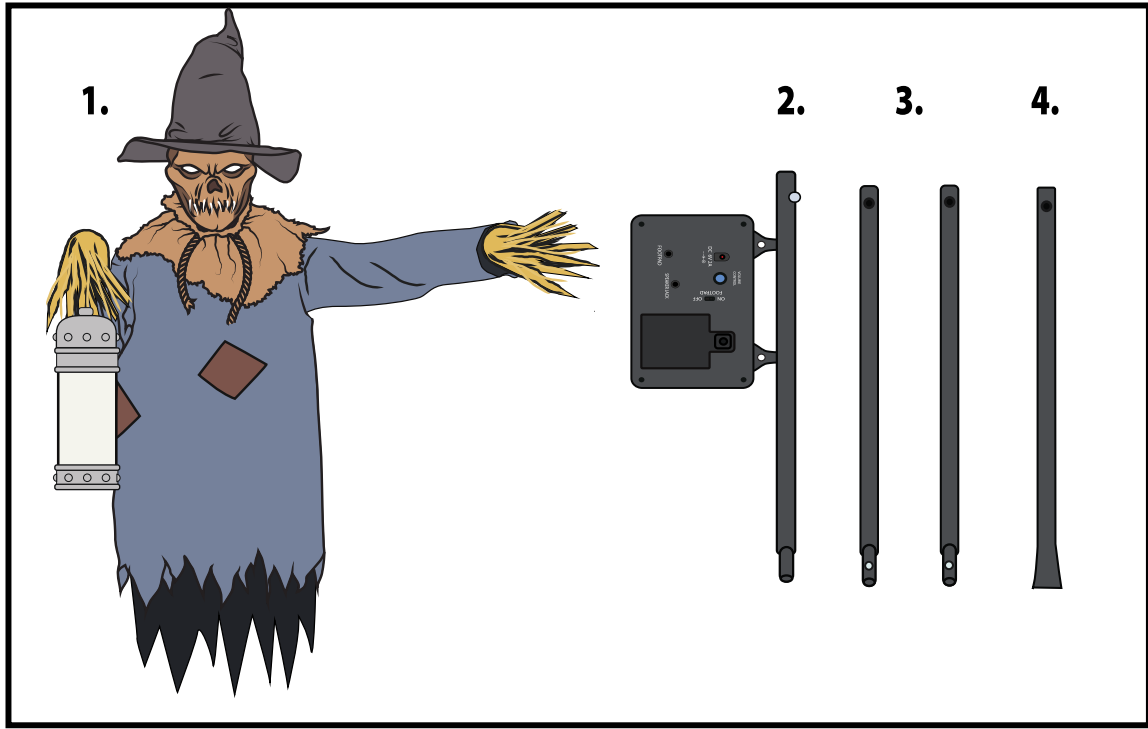

PARTS

1. SCARECROW AND LANTERN
2. UPPER POLE AND MODULE
3. CENTER POLES (QTY 2)
4. LOWER POLE

1. Snap lock the CENTER POLE into the LOWER POLE. (Match A to A)
2. Snap lock the CENTER POLE into the top of the CENTER POLE. (Match B to B)
3. Snap lock the UPPER POLE and MODULE into the top of the CENTER POLE. (Match C to C)
4. Snap lock the UPPER POLE AND MODULE under the neck and inside the fabric of the SCARECROW AND LANTERN. (Match D to D)
5. Connect the wires labeled E located inside the fabric of the SCARECROW AND LANTERN. (Connect to E to E)
6. Connect the wires labeled F located inside the fabric of the SCARECROW AND LANTERN. (Connect to F to F)
7. Reach inside the fabric on the SCARECROW AND LANTERN. Connect 6V 2A ADAPTER (not included) or insert 4 AA alkaline batteries (not included) into the battery compartment located on the MODULE. Turn the switch to the ON position to activate the item. Move in front of the item or make a loud sound (clap) to activate. Turn item OFF when not in use.
8. Use a screwdriver or other tool to start a stake hole in the ground. Firmly push the LOWER POLE into the ground and pose the SCARECROW AND LANTERN.

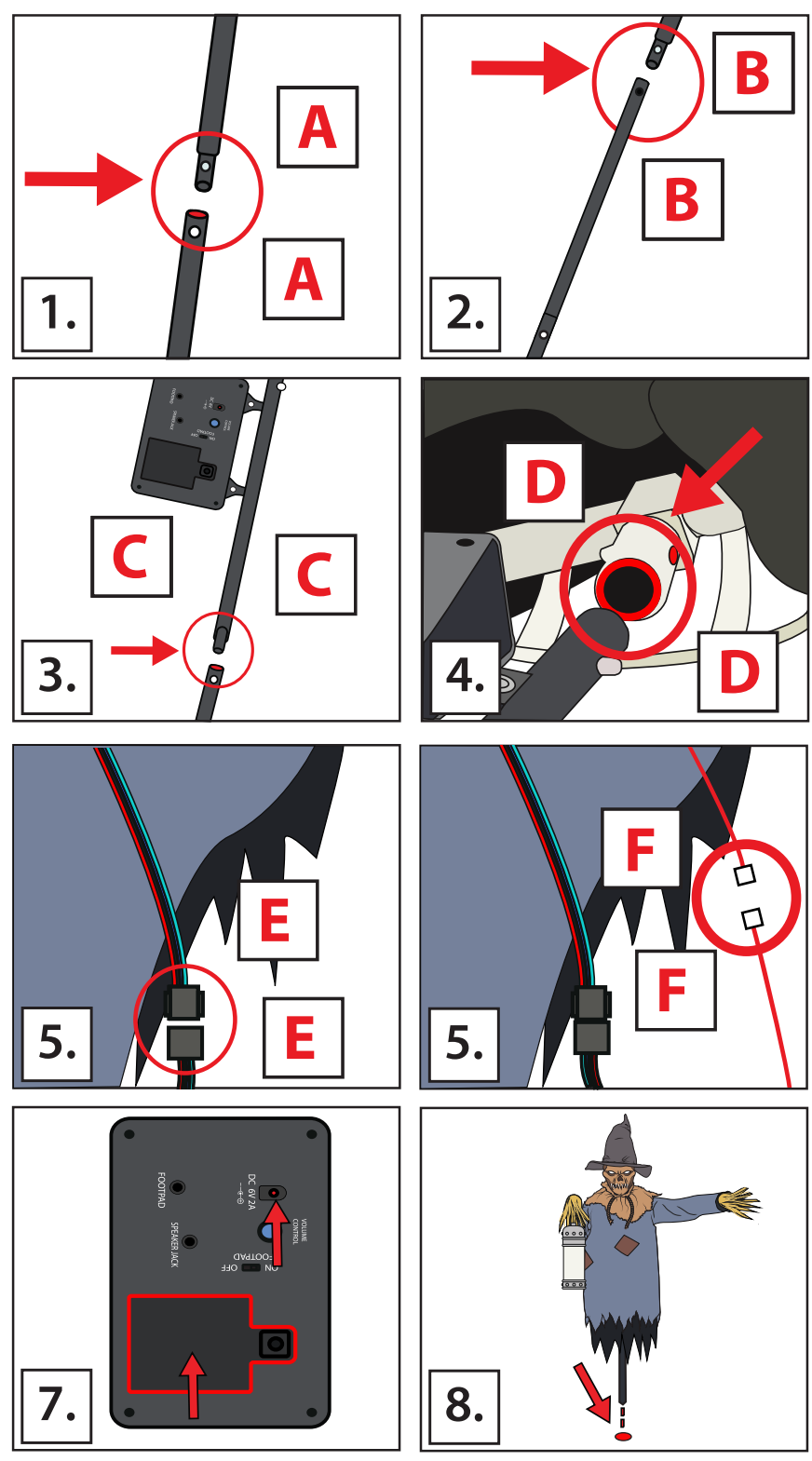

OPTIONAL EXTERNAL SPEAKER SET UP
EXTERNAL SPEAKER IS NOT INCLUDED. MUST BE PURCHASED SEPARATELY.

1. Plug speaker cord into the jack labeled SPEAKER JACK located on side on the MODULE.
2. Use volume knob on external speaker to control volume levels.

OPTIONAL FOOTPAD SET UP
FOOTPAD IS NOT INCLUDED. MUST BE PURCHASED SEPARATELY.

1. Insert the cable from optional footpad into the jack labeled FOOTPAD on the MODULE.
2. Place the switch in the FOOTPAD position to enable FOOTPAD activation.
3. Step on the FOOTPAD to activate the scary sequence!

* Footpads and adapters are sold separately and can be purchased at www.tekkyaccessories.com

SMART PHONE SCAN
SETUP VIDEO

BATTERY INSTRUCTIONS AND CAUTIONS
Battery installation and removal should be performed by an adult. Remove batteries when not in use. Use only batteries recommended in the instructions. Do not mix new and used batteries. Do not mix alkaline, carbon-zinc, nickel-cadmium, rechargeable or different types of batteries. Be mindful to insert batteries with the correct polarity (+/-) as indicated. Remove all exhausted batteries. Rechargeable batteries are only to be charged under adult supervision. Rechargeable batteries are to be removed from the item before being charged. Non-rechargeable batteries are not to be recharged. The supply terminals are not to be short-circuited. Always dispose of exhausted batteries properly. Do NOT dispose of batteries in fire, they may leak or explode.

Warning! This item is not a toy. For decoration only. Small parts, choking hazard. This product is intended for use by persons 15 years of age and older. Not intended for use by children ages 14 years and younger.

WARNING
DO NOT TURN ITEM ON UNTIL YOU HAVE COMPLETELY FINISHED ASSEMBLY.
STAY CLEAR OF ITEM WHILE OPERATING.
DO NOT PLACE ITEM ON UNEVEN GROUND.
DO NOT PLACE WEIGHT ON ITEM WHILE IN OPERATION.



DO NOT RETURN THIS ITEM TO THE STORE!
If experiencing technical difficulties, please go to www.tekkydesign.com for assistance.



visit us at tekkydesign.com
Requires 6V 2A ADAPTER (included) or 4AA batteries (not included)
ALL NEW MATERIALS:
METAL, FOAM, PLASTIC, POLYESTER
Surface washable only.



LANTERN JACK™ is a trademark of Tekky.
Copyright © 2021 Tekky.
All Rights Reserved.
MADE IN CHINA